

TOWNSHIP 1 N., RANGE 6 W.W.M. TILLAMOOK CO. ORE.

TILL. DATED FEB 1974 To Forest Grove

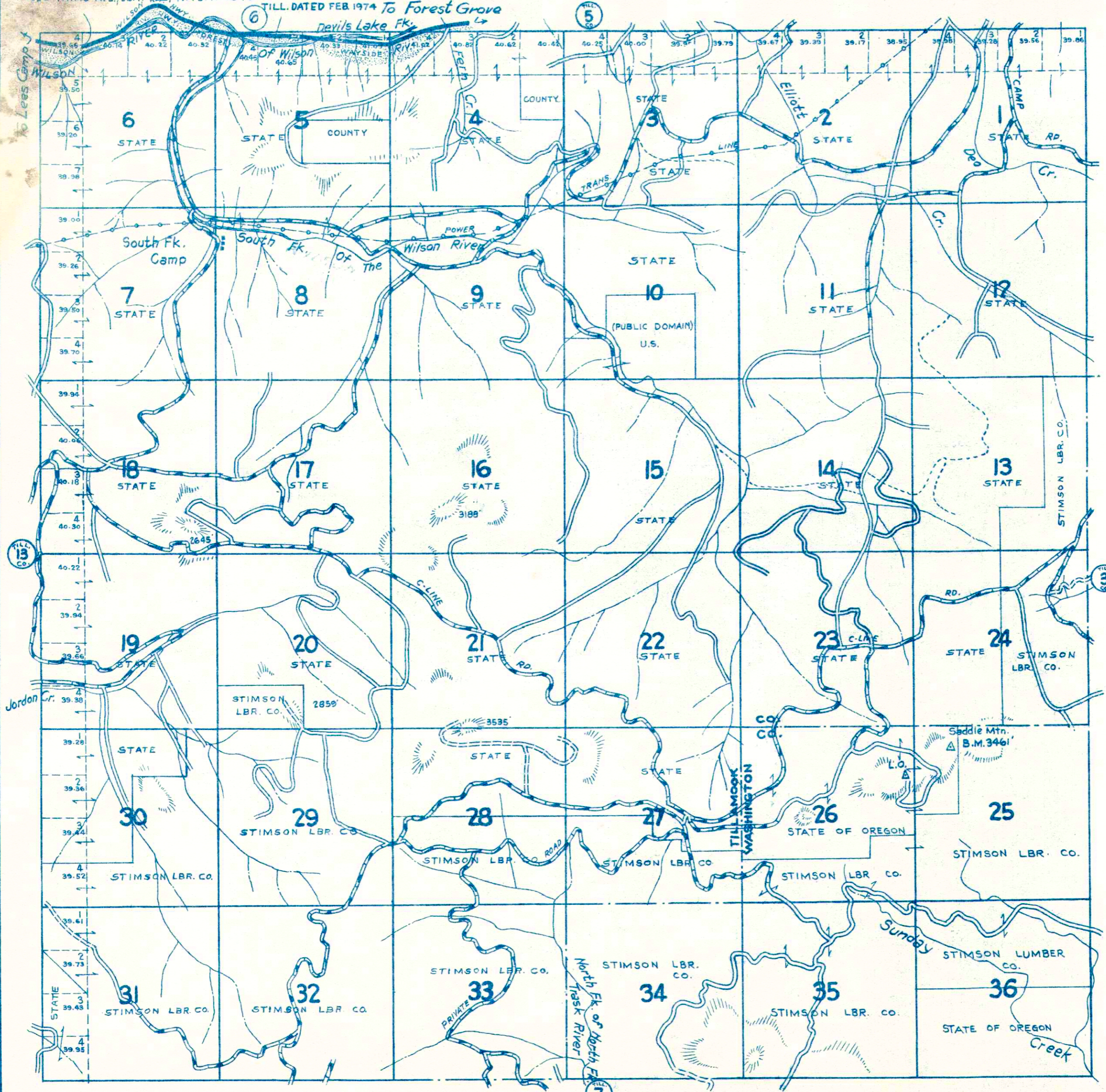

Reproduction in whole or part for personal use or resale is prohibited by law.

LEGEND

STATE HWY. ⑥	U.S. HWY. 101
PAVED HIGHWAYS	—————
IMPROVED DIRT ROADS	———
DIET ROADS	———
INFERIOR ROADS	———
RAILROADS	———
TRAILS	———
INTERMITTENT CREEKS	~~~~~
NAT'L FOREST BDRYS.	xxxxxx
ELEC. PWR. TRANS. LINES	—o—o—